

Curbs Plus, Inc.

8767 Alabama Hwy
 Ringgold, GA 30736
 PH (706) 858-1188 / FAX (706) 866-2339

APPROVED BY: _____

DATE APPROVED: _____

CPT-1 Transition-Curb System

STANDARD FEATURES

1. 14 Ga. Prime Galvanized Steel Construction
2. Fully Welded Watertight One-piece Construction
3. Primed Painted after Fabrication
4. 1" Thick Neoprene Faced Fiberglass Insulation
5. Closure Angles
6. Load Distributing Internal Reinforcement (As Required)
7. Duct Supports & Gasketing (when Required)
8. Sloped Extensions to Eliminate Standing Water

OPTIONS:

- 1.
- 2.
- 3.
- 4.

PROJECT NAME: _____

CITY, STATE: _____

CUSTOMER: _____

JOB NUMBER: _____

Note:

*** (1) Base Dimension = Curb O.D. plus 1-1/2" on all "Insulated" Conventi Roof Curbs (CPC-1, 2, 3) and, 1/2" on all Metal Building Roof Cu and "Non-Insulated" Conventional Roof Curbs (CPC-4, 5).

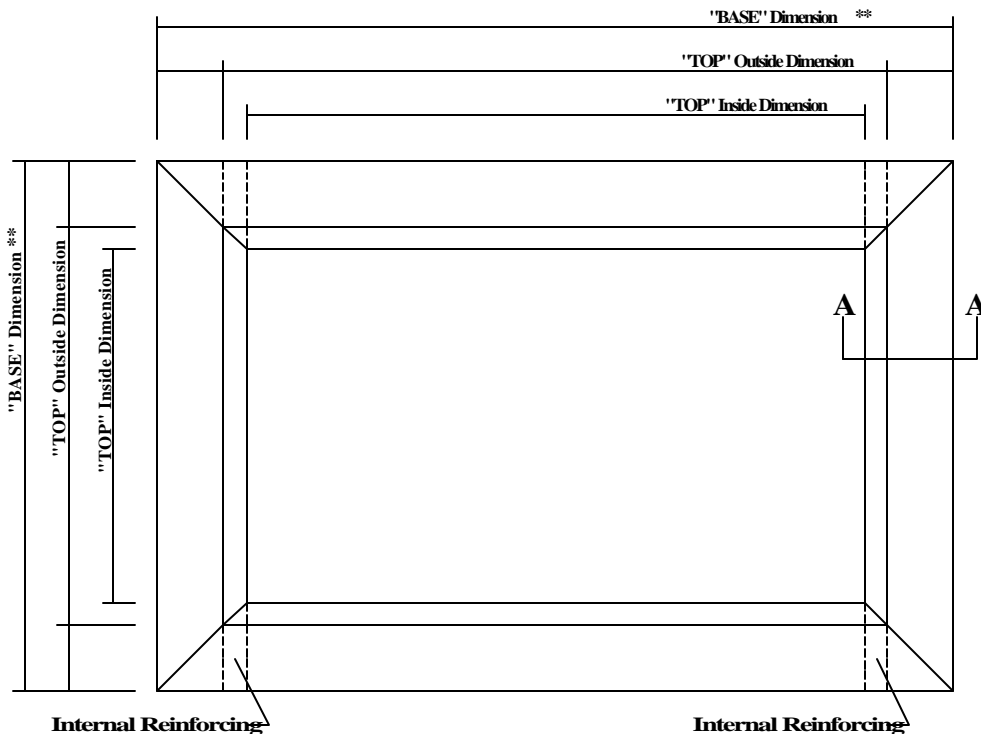

PLAN VIEW

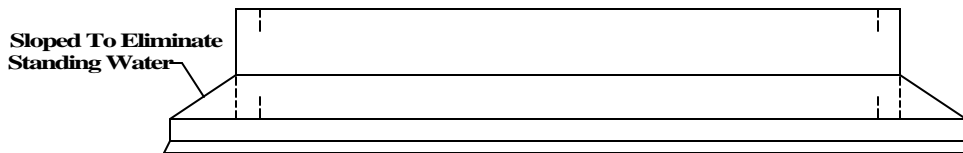

ELEVATION

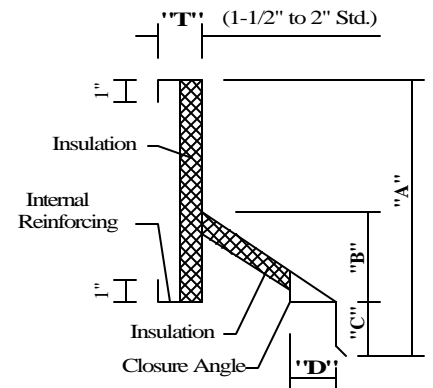

SECTION A-A

QTY.	"BASE" DIM.	"TOP" INSIDE DIM.	"TOP" OUTSIDE DIM.	"T"	"A"	"B"	"C"	"D"	TAG
	X	X	X						